

Product Overview



INDUSTRIAL
PLUGS & SOCKETS





About half a century competence and experience

Bals stands worldwide as a quality brand for innovation, reliability and service. For more than 60 years, we have been producing CEE plugs and connectors for the world markets. From day one we have focussed on the highest level of quality "Made in Germany". Our factories in Kirchhundem-Albaum and Freiwalde have highly skilled and motivated teams, the very latest manufacturing facilities

and a highly efficient logistics system.

Our product portfolio ranges from plugs, phase inverters, connectors, sockets outlets and combinations units to charging plugs and sockets for electrical vehicles. Numerous certifications from German and foreign certification institutes, as well as registered designs and patents, document the high technical standard of our products.



Two modern factories a consistent quality standard

From the beginning the headquarters of our company is located in Kirchhundem-Albaum (North-Rhine-Westphalia). Product development, marketing and sales, as well as administration are located here. In addition, plug and socket systems and special products are manufactured in the Kirchhundem-Albaum factory. The factory in Freiwalde (Brandenburg), built in 1994 and expanded many times since, has state-of-the-art production facilities for fully-automatic manufacturing of unique CEE plugs and connectors as well as a highly-effective logistics centre manufacturing of unique CEE plugs and connectors as well as a highly-effective logistics centre.



CEE plugs and connectors for the world market

As an independent, medium-sized, family-owned company, we produce standardised industrial plugs and sockets acc. to IEC 60309 1-2 as well as plug and socket systems, distributors and components for the infrastructure of electrical vehicles. We set new technical standards with innovations and ground-breaking, partially patented new developments such as MULTI-GRIP or QUICK-CONNECT. The export rate in excess of 50 percent shows: Our solutions are highly valued around the world. Our products are sold in more than 80 countries. Subsidiaries and exclusive partners in strategically important countries only sell our products.



Our responsibility to the highest quality

Quality does not permit any compromise. This has always been the maxim at Bals. The ISO-9001-certified production process in all factories ensures the well-known high product quality. This proof of quality is reflected in patents, certificates from German and foreign testing institutes, as well as the specification of Bals products by highly renowned companies. Innovation is an important quality benchmark for us. This way, we are always setting new standards with intelligent solutions that bring the user sustainable advantages.



QUICK-CONNECT by Bals.

QUICK CONNECT

With the introduction of this screwless connection technology in 1998, Bals again set new standards. We were the first company to offer this reliable and timesaving innovation. The patented system, which has unbeatable advantages over previously used screw connections, quickly developed into the industry standard.

As the only manufacturer worldwide, it goes without saying that Bals offers a screwless terminal connection for plugs and sockets even for an amperage of 63A. Also truly unique are the 16A and 32A QUICK-CONNECT phase inverters.

VARIABOX

The distributor generation

One for all: the VARIABOX meets all requirements for a modern distributor housing and can be individually configured in five different sizes. With versions S, M, L, XL and XXL, as surface-mounting or mobile combination, we always have the right distributor for your needs.



e MOBILE

Strong connections for tomorrow's eMobility

eMobile by Bals offers a wide range of components and many suitable solutions for electromobility. As one of only few manufacturers, Bals offers the appropriate systems according to type 1 as well as type 2 and can thus provide plug-in devices as per IEC 62196-2 for European car models as well as for overseas electric vehicles.

The company delivers components to numerous manufacturers of charging stations, energy supply companies, municipal utilities and facility management companies.



EVOBOX

The portable distributor series

The new EVOBOX series is the ideal solution for mobile power supply in industry, on construction sites or in event technology. The portable distributor series is available in 4 coordinated housing sizes and impresses with its high mechanical and thermal capacity.



QUICK-CONNECT technology in detail.

QUICK CONNECT

- Invented in 1998 and patented by Bals: the screwless quick connection technology based on the spring-clamp principle
- Time savings of up to 75% over other conventional connection technologies
- Faster, more reliable and, above all, more controlled conductor connection
- The terminal accepts all types of copper conductors, rigid or flexible, with or without wire end ferrule as well as conductors of all quality grades irrespective of the conductor diameter or conductor insulation
- No wire end ferrules needed
- On delivery, the terminals are open and the contact pressure of the springs is optimally set
- Pressing the contact slide or locking lever with a finger visibly, audibly, reliably and permanently closes the terminal after the stripped conductor has been inserted
- Rewiring is no problem.
Pressing the locking lever or contact slide again releases the conductor; unlike insulation displacement connector technology, the conductor can then be used again without needing further processing steps.
- The damage-free conductor clamping guarantees an optimum connection over the entire service life
- QUICK-CONNECT is maintenance-free, insensitive to shocks, vibrations and temperature fluctuations

The following conductor cross sections can be used in the QUICK-CONNECT plugs and sockets:

QUICK-CONNECT plugs and connectors 16A:	1 mm ² - 2.5 mm ²	(flexible conductors)
QUICK-CONNECT panel and Surface Mounting Socket Outlets 16A:	1.5 mm ² - 4 mm ²	(rigid and multi-wire conductors)
QUICK-CONNECT plugs and connectors 32A:	2.5 mm ² - 10 mm ²	(flexible conductors)
QUICK-CONNECT panel and Surface Mounting Socket Outlets 32A:	2.5 mm ² - 10 mm ²	(rigid and multi-wire conductors)
QUICK-CONNECT plugs and connectors 63A:	6 mm ² - 16 mm ²	(flexible conductors)
QUICK-CONNECT panel and Surface Mounting Socket Outlets 63A:	6 mm ² - 25 mm ²	(rigid and multi-wire conductors)



The QUICK-CONNECT range leaves no wish unfulfilled



QUICK-CONNECT connection technology 63A



MULTI-GRIP available from 16A to 125A.

MULTI-GRIP

- Cable gland system with integrated strain relief, invented by Bals in 2002
- The special cable gland is secured against self-loosening and unintentional loosening when inserting and withdrawing the plug by means of a buttress thread
- The rubber seal which is permanently joined to the enclosure cannot be lost. The time-consuming adjustment of the onion rings to the cable diameter is no longer necessary
- Simply tighten the Multi-Grip cable gland for damage-free, airtight and permanent mounting of the cable without any kind of deformation.
- MULTI-GRIP cable glands achieve at least protection degree IP67
- Water no longer remains in the flared opening; it is instead forced out through the drainage openings
- The exterior strain relief system sits against the captive seal and prevents the penetration of water or dirt into the connection cavity of the plug even if the cable is moved
- The tensile strength exceeds the values specified in standards IEC 60309, EN 60309, VDE 0623 many times over
- The condition of the strain relief system can be inspected at any time from the outside without opening the plug enclosure

MULTI-GRIP easily adapts to almost all cable and wire types! The following cable diameters can be fed in without affecting the tightness or capacity for strain relief.

TE- and TE-Plus plugs	Cable diameter	TLS- and QC standard plugs and socket	Cable diameter
16A 3 and 4pole TE and TE-Plus	Ø8 mm - Ø18 mm	TLS 16A 3 to 5pole	Ø8 mm - Ø18 mm
16A 5pole TE and TE-Plus	Ø10 mm - Ø21 mm	TLS 32A 3 to 5pole	Ø11 mm - Ø23 mm
32A 3 and 4pole TE and TE-Plus	Ø11 mm - Ø23 mm	QC standard 16A 3 to 5pole	Ø8 mm - Ø18 mm
32A 5pole TE and TE-Plus	Ø13 mm - Ø27 mm	QC standard 32A 3 to 5pole	Ø11 mm - Ø23 mm
63A 3 to 5pole TE and TE-Plus	Ø16 mm - Ø36 mm		
125A 3 to 5pole TE	Ø26 mm - Ø50 mm		

A reducer is available for all 16A plugs and sockets. It allows cable diameters of less than Ø 8 mm to be sealed tightly.

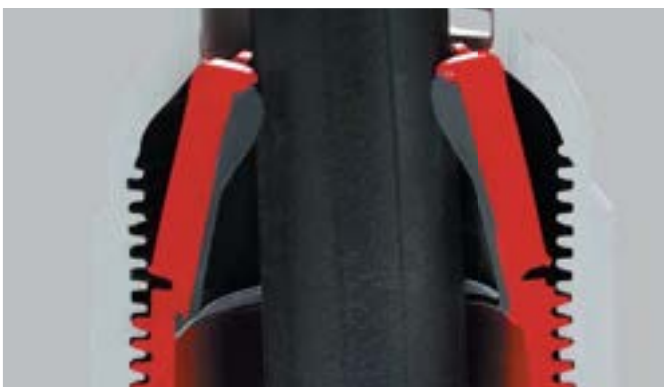

Permanently attached, captive seal



MULTI-GRIP cable gland achieves protection degree IP67

All Bals plugs and sockets are:

Impact-resistant, even at extremely low temperatures	Tested to -25°C
Dimensionally stable, even with high heat generation	Glow wire test at 650°C and 850°C
Protected against splashing water, watertight and dust-proof in accordance with protection degrees IP44 and IP67	Tests in accordance with DIN EN 60529, e.g. at water depth of 1 m
High switching capacity, can therefore also be connected and disconnected under load	Contacts and insert are subjected to a continuous mechanical, electrodynamic and thermal load
Ageing resistant	Long-term testing at a temperature of 80°C
Good electrical insulation properties	Plastic parts used insulate voltages of ≥ 2500 V~
Dimensionally stable and abrasion-resistant	Tested through years of use under harsh operating conditions
Environmentally friendly	Plugs and sockets are PVC-free, cadmium-free and halogen-free

The same generally applies for the plug/socket combination systems as for plugs and sockets, whereby here it is particularly important to take resistance against chemicals into consideration. The high-quality plastics and solid rubber used are suitable for the majority of applications. If, however, chemicals are used (e.g. for cleaning tasks in food processing plants), it may be necessary to use a different material (see "Material resistance list" on page 21) or contact us.



Glow wire test



Immersion test

TLS Plug with MULTI-GRIP

- Screw terminals
- Cable gland Multi-Grip system
- One-piece housing
- Protection degree IP44

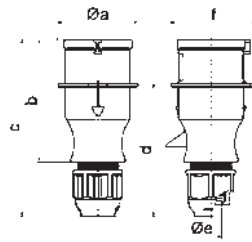

A	16/20	16/20	16/20	32	32	32	A	P	V	Art. No.
P	3	4	5	3	4	5				
a ø	54,0	60,0	66,0	71,0	71,0	80,0	16/20	3	230	21001
b	94,5	98,0	101,0	115,0	115,0	119,0				
c	138,0	142,0	145,0	170,0	170,0	174,0	16/20	4	400	215
d	101,5	105,5	108,5	124,0	124,0	128,0				
e ø	18,0	18,0	18,0	23,0	23,0	23,0	16/20	5	400	203
f	56,6	64,0	71,0	76,0	76,0	85,0				
							32	3	230	21013
							32	4	400	2118
							32	5	400	204

MULTI-GRIP

204

2 MB 129

TE Plug with MULTI-GRIP

- Screw terminals
- Nickel plated contacts
- Cable gland Multi-Grip system
- Housing connection with thread and snap-in lock
- Protection degree IP44

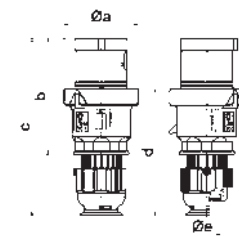

A	63	A	P	V	Art. No.
P	5				
a ø	96,0	63	3	230	2104
b	153,0				
c	233,0	63	4	400	2151
d	167,0				
e ø	36,0	63	5	400	21590

MULTI-GRIP

21590

2 MB 158

TLS Plug with MULTI-GRIP

- Screw terminals
- Nickel plated contacts
- Cable gland Multi-Grip system
- One-piece housing
- Protection degree IP67

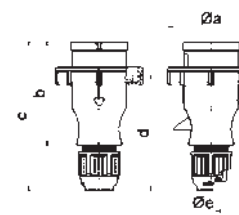

A	16/20	16/20	16/20	32	32	32	A	P	V	Art. No.
P	3	4	5	3	4	5				
a ø	70,0	78,0	86,0	94,0	94,0	101,0	16/20	3	230	210576
b	94,5	98,0	101,0	115,0	115,0	119,0				
c	138,0	142,0	145,0	170,0	170,0	174,0	16/20	4	400	21349
d	105,5	109,5	112,5	128,0	128,0	132,0				
e ø	18,0	18,0	18,0	23,0	23,0	23,0	16/20	5	400	21239
							32	3	230	210594
							32	4	400	21351
							32	5	400	210607

MULTI-GRIP

210607

2 MB 130

TE Plug with MULTI-GRIP

- Screw or screwless terminals
- High temperature resistant contact carrier
- Nickel plated contacts
- Cable gland Multi-Grip system
- Housing connection with thread and snap-in lock
- Protection degree IP67

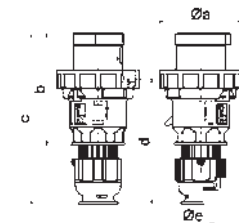

A	63	125	A	P	V	Art. No.
P	5	5				
a ø	113,5	126,0	63	3	230	2181
b	153,0	181,0				
c	233,0	282,0	63	4	400	2185
d	171,0	206,0				
e ø	36,0	50,0	63	5	400	2189
			125	3	230	2191
			125	4	400	2195
			125	5	400	2199

MULTI-GRIP

2189

2 MB 159/214

Angled Plug

- Screw terminals
- With short cable sleeve
- Protection degree IP44

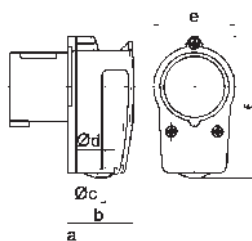

A	16/20	A	P	V	Art. No.
P	3				
a	80,0	16	3	230	231
b	44,0				
c ø	6,5				
d ø	18,0				
e	51,0				
f	90,0				

231

2 MB 12

TLS Connector with MULTI-GRIP

- Screw terminals
- Cable gland Multi-Grip system
- One-piece housing
- Protection degree IP44

MULTI-GRIP

304

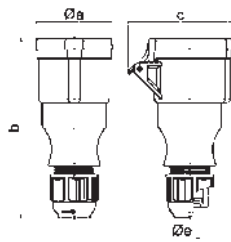

3 MB 82

A	16/20	16/20	16/20	32	32	32	A	P	V	Art. No.
P	3	4	5	3	4	5				
a ø	51,0	58,0	65,0	67,0	67,0	73,0	16/20	3	230	31001
b	145,0	148,0	156,0	185,0	185,0	185,0				
c	74,0	84,0	90,0	94,0	94,0	102,0	16/20	4	400	315
e ø	18,0	18,0	18,0	23,0	23,0	23,0				
							16/20	5	400	303
							32	3	230	31013
							32	4	400	3118
							32	5	400	304

Connector with MULTI-GRIP

- Screw or screwless terminals
- Nickel plated contacts
- Cable gland Multi-Grip system
- Housing connection with thread and snap-in lock
- Protection degree IP44

MULTI-GRIP

3112

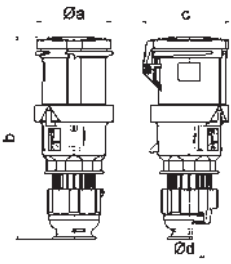

3 MB 107

A	63	A	P	V	Art. No.
P	5				
a ø	95,0	63	3	230	3104
b	251,0				
c	109,0	63	4	400	3151
d ø	36,0				
		63	5	400	3112

TLS Connector with MULTI-GRIP

- Screw terminals
- Nickel plated contacts
- Cable gland Multi-Grip system
- One-piece housing
- Protection degree IP67

MULTI-GRIP

31247

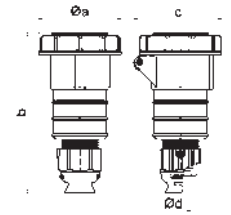

3 MB 81

A	16/20	16/20	16/20	32	32	32	A	P	V	Art. No.
P	3	4	5	3	4	5				
a ø	70,5	78,0	86,5	94,0	94,0	101,5	16/20	3	230	310333
b	154,0	155,0	160,0	190,0	190,0	190,0				
c	77,0	83,0	93,0	99,0	107,0	107,0	16/20	4	400	31241
e ø	18,0	18,0	18,0	23,0	23,0	23,0				
							16/20	5	400	31243
							32	3	230	31244
							32	4	400	31245
							32	5	400	31247

TE Connector with MULTI-GRIP

- Screw or screwless terminals
- High temperature resistant contact carrier
- Nickel plated contacts
- Cable gland Multi-Grip system
- Housing connection with thread and snap-in lock
- Protection degree IP67

MULTI-GRIP

3124

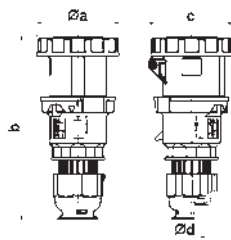

3 MB 109/131

A	63	125	A	P	V	Art. No.
P	5	5				
a ø	110,0	125,0	63	3	230	3181
b	251,0	300,0				
c	113,0	128,0	63	4	400	3185
d ø	36,0	50,0				
			63	5	400	3124
			125	3	230	3191
			125	4	400	3195
			125	5	400	3199

Panel Mounting Appliance Inlet

- Screw terminals
- Protection degree IP44

2600



5 MB 24

A	16/20	16	/2032	32	A	P	V	Art. No.
P	3	5	3	5				
a	74,0	84,0	90,0	90,0	16/20	3	230	261
b	84,0	84,0	75,0	75,0				
c	58,0	64,0	78,0	78,0	16/20	5	400	2612
d	64,0	64,0	45,0	45,0				
e ø	5,5	5,5	5,5	5,5	32	3	230	2662
f	12,0	7,0	7,0	7,0				
g	70,0	78,0	86,0	88,0	32	5	400	2600
h	128,0	129,0	138,0	140,0				
i	-	-	13,0	13,0				

Appliance Inlet with Flange

- Screw terminals
- Flange 75 x 75 mm
- Nickel plated contacts
- Protection degree IP44



2815

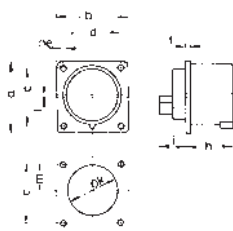

5 MB 39

A	16/20	16/20	32	32	A	P	V	Art. No.
P	3	5	3	5				
a	75,0	75,0	75,0	75,0	16/20	3	230	2817
b	75,0	75,0	75,0	75,0				
c	60,0	60,0	60,0	60,0	16/20	5	400	2814
d	60,0	60,0	60,0	60,0				
e ø	5,5	5,5	5,5	5,5	32	3	230	2827
f	7,0	7,0	7,0	7,0				
h	43,0	43,0	53,0	53,0	32	5	400	2815
i	24,0	24,0	30,0	30,0				
k ø	42,0	61,0	57,0	57,0				
l	-	5,0	2,0	-				
m	30,0	25,0	28,0	30,0				

Surface Mounting Socket Outlet

- Screw terminals
- Protection degree IP44
- Cable entry 1x at top (open), 2x at bottom (closed)
- Base rotatable by 180°



101

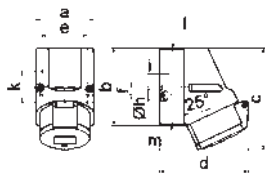

1 MB 7

A	16/20	16/20	16/20	32	32	32	A	P	V	Art. No.
P	3	4	5	3	4	5				
a	64,0	75,0	75,0	83,0	83,0	83,0	16/20	3	230	111
b	87,0	100,0	100,0	126,0	126,0	126,0				
c	117,0	129,0	131,0	155,0	155,0	155,0	16/20	4	400	11645
d	103,0	108,0	116,0	130,0	130,0	136,0				
e	51,0	59,0	59,0	68,0	68,0	68,0	16/20	5	400	100
f	-	11,0	11,0	11,0	11,0	11,0				
h ø	4,1	5,1	5,1	5,5	5,5	5,5	32	3	230	11651
i	4,5	4,5	4,5	6,5	6,5	6,5				
k	40,0	-	-	80,0	80,0	80,0	32	4	400	11646
l	M20	M20	M20	M25	M25	M25				
m	for M20	for M20	for M20	2xM25	2xM25	2xM25	32	5	400	101

Surface Mounting Socket Outlet

- Cable entry 1x at top (open), 2x at bottom (closed)
- Base rotatable by 180°
- Nickel plated contacts
- Kontex contact
- Box terminals
- Protection degree IP44



1124

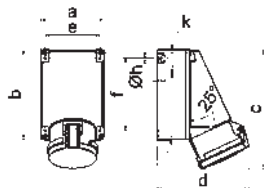

1 MB 4

A	63	A	P	V	Art. No.
P	5				
a	118,0	63	3	230	1104
b	170,0				
c	223,0	63	4	400	1127
d	168,0				
e	104,0	63	5	400	1124
f	136,0				
h	6,1				
i	6,0				
k	M40				
l	M32/32				

Surface Mounting Socket Outlet

- Screw terminals
- Cable entry 1x at top (open), with 16A 1x and with 32A 2x at bottom (closed)
- Base rotatable by 180°
- Protection degree IP67



1155

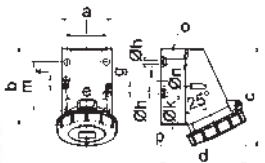

1 MB 13

A	16/20	16/20	16/20	32	32	32	A	P	V	Art. No.
P	3	4	5	3	4	5				
a	64,0	75,0	75,0	83,0	83,0	83,0	16/20	3	230	1133
b	87,0	100,0	100,0	126,0	126,0	126,0				
c	115,0	130,0	130,0	160,0	160,0	160,0	16/20	4	400	1137
d	103,0	110,0	115,0	129,0	129,0	135,0				
e	51,0	59,0	59,0	68,0	68,0	68,0	16/20	5	400	1143
f	20,0	11,0	11,0	11,0	11,0	11,0				
g	20,0	-	-	-	-	-	32	3	230	1145
h	4,1	5,1	5,1	5,5	5,5	5,5	32	4	400	1149
i	4,5	45,5	4,5	6,5	6,5	6,5				
k	-	-	-	65,0	65,0	65,0				
l	-	-	-	80,0	80,0	80,0	32	5	400	1155
m	-	-	-	10,0	10,0	10,0				

Surface Mounting Socket Outlet

- Cable entry 1x at top (open), 1x at bottom (closed)
- Nickel plated contacts
- Base rotatable by 180°
- Kontex contact
- Box terminals
- Protection degree IP67



1112

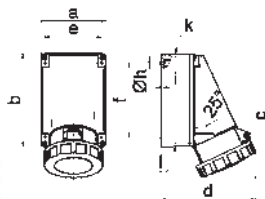

1 MB 3

A	63	A	P	V	Art. No.
P	5				
a	118,0	63	3	230	1157
b	170,0				
c	228,0	63	4	400	1161
d	176,0				
e	104,0	63	5	400	1112
f	136,0				
h	6,1				
i	6,0				
k	M40				
l	M32/32				

Surface Mounting Socket Outlet

- Screw terminals
- Cable entry 1x M50 at top
- High-temperature-resistant contact carrier
- Kontex contact
- Nickel plated contacts
- Box terminals
- Protection degree IP67



11447

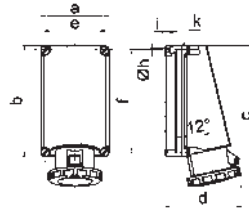

1 MB 20

A	125	A	P	V	Art. No.
P	5				
a	160,0	125	3	230	11427
b	260,0				
c	330,0	125	4	400	11441
d	168,0				
e	140,0	125	5	400	11447
f	240,0				
ø h	8,3				
i	10,0				
k	M50				

Panel Mounting Socket Outlet

- Angled 20°
- Screw terminals
- Flange 85 x 85 mm
- Protection degree IP44



1215

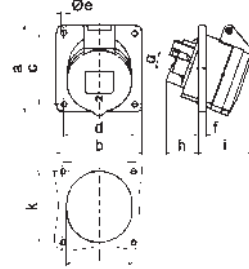

4 MB 26

A	16/20	16/20	16/20	32	32	32	A	P	V	Art. No.
P	3	4	5	3	4	5				
a	85,0	85,0	85,0	85,0	85,0	85,0	16/20	3	230	1217
b	85,0	85,0	85,0	85,0	85,0	85,0				
c	70,0	70,0	70,0	70,0	70,0	70,0	16/20	4	400	1221
d	70,0	70,0	70,0	70,0	70,0	70,0				
e ø	5,5	5,5	5,5	5,5	5,5	5,5	16/20	5	400	12078
f	8,0	8,0	8,0	8,0	8,0	8,0				
h	30,0	30,0	30,0	50,0	50,0	50,0	32	3	230	12310
i	48,0	50,0	54,0	63,0	63,0	60,0				
k	57,0	65,0	70,0	78,0	78,0	78,0	32	4	400	1233
l	57,0	65,0	70,0	78,0	78,0	78,0				
α	20°	20°	20°	20°	20°	20°	32	5	400	1215

Panel Mounting Socket Outlet

- Angled
- Screw terminals
- High temperature resistant contact carrier
- Flange 100 x 92 mm
- Protection degree IP44



12380

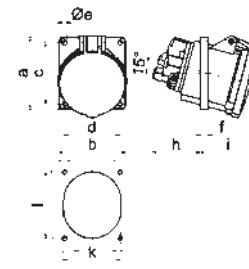

4 MB 64

A	63	A	P	V	Art. No.
P	5				
a	100,0	63	3	230	12135
b	92,0				
c	85,0	63	5	400	12380
d	77,0				
e ø	6,5				
f	12,0				
h	65,0				
i	81,0				
k	80,0				
l	92,0				

Panel Mounting Socket Outlet

- Straight
- Screw terminals
- Flange 75 x 75 mm
- Protection degree IP44



1333

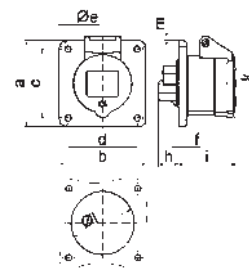

4 MB 4

A	16/20	16/20	16/20	32	32	32	A	P	V	Art. No.
P	3	4	5	3	4	5				
a	75,0	75,0	75,0	75,0	75,0	75,0	16/20	3	230	131
b	75,0	75,0	75,0	75,0	75,0	75,0				
c	60,0	60,0	60,0	60,0	60,0	60,0	16/20	4	400	1324
d	60,0	60,0	60,0	60,0	60,0	60,0				
e ø	5,5	5,5	5,5	5,5	5,5	5,5	16/20	5	400	132001
f	7,0	7,0	7,0	8,0	8,0	8,0				
h	17,0	26,0	17,0	36,0	36,0	19,0	32	3	230	13007
i	51,0	53,0	53,0	62,0	62,0	62,0				
k	70,0	80,0	85,0	90,0	90,0	98,0	32	4	400	13011
l ø	45,0	45,0	55,0	60,0	60,0	60,0				
m	3,5	7,0	11,5	12,0	12,0	17,0	32	5	400	1333

Panel Mounting Socket Outlet

- Straight
- Screw or screwless terminals
- High temperature resistant contact carrier
- Flange 107 x 100 mm
- Protection degree IP44



136

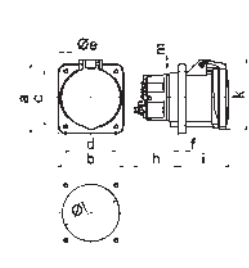

4 MB 8

A	63	A	P	V	Art. No.
P	5				
a	107,0	63	3	230	1307
b	100,0				
c	85,0	63	4	400	134
d	77,0				
ø e	6,5	63	5	400	136
f	12,0				
h	67,0				
i	77,0				
k	110,0				
ø l	88,0				
m	7,0				

Panel Mounting Socket**Outlet**

- Angled 20°
- Screw terminals
- Flange 85 x 85 mm
- Protection degree IP67



1288

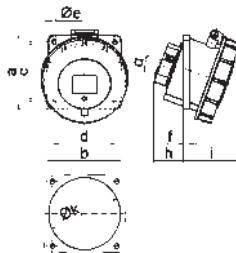

4 MB 22

A	16/20	16/20	16/20	32	32	32	A	P	V	Art. No.
P	3	4	5	3	4	5				
a	85,0	85,0	85,0	85,0	85,0	85,0	16/20	3	230	1266
b	85,0	85,0	85,0	85,0	85,0	85,0				
c	70,0	70,0	70,0	70,0	70,0	70,0	16/20	4	400	1270
d	70,0	70,0	70,0	70,0	70,0	70,0				
e	5,5	5,5	5,5	5,5	5,5	5,5	16/20	5	400	1276
f	8,0	8,0	8,0	8,0	8,0	8,0				
h	30,0	30,0	30,0	50,0	50,0	34,0	32	3	230	1278
i	55,0	57,0	59,0	67,0	67,0	69,0				
k	57,0	65,0	70,0	78,0	78,0	78,0	32	4	400	1282
l	57,0	65,0	70,0	78,0	78,0	78,0				
α	20°	20°	20°	20°	20°	20°	32	5	400	1288

Panel Mounting Socket**Outlet**

- Angled
- Screw or screwless terminals
- High temperature resistant contact carrier
- Flange 100 x 92 mm (at 63A)
- Flange 114 x 114 mm (at 125A)
- Protection degree IP67



129

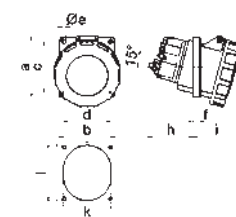

4 MB 65/9

A	63	125	A	P	V	Art. No.
P	5	5				
a	100,0	114,0	63	3	230	12001
b	92,0	114,0				
c	85,0	90,0	63	4	400	1200
d	77,0	90,0				
e	6,5	6,5	63	5	400	129
f	12,0	12,0				
h	65,0	82,0	125	3	230	12100
i	80,0	90,0				
k	80,0	92,0	125	4	400	12104
l	92,0	105,0				
			125	5	400	12108

Panel Mounting Socket**Outlet**

- Straight
- Screw terminals
- Flange 75 x 75 mm
- Protection degree IP67



1370

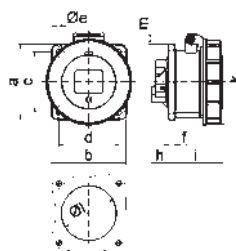

4 MB 5

A	16/20	16/20	16/20	32	32	32	A	P	V	Art. No.
P	3	4	5	3	4	5				
a	75,0	75,0	75,0	75,0	75,0	75,0	16/20	3	230	1372
b	75,0	75,0	75,0	75,0	75,0	75,0				
c	60,0	60,0	60,0	60,0	60,0	60,0	16/20	4	400	1376
d	60,0	60,0	60,0	60,0	60,0	60,0				
e	5,5	5,5	5,5	5,5	5,5	5,5	16/20	5	400	1382
f	7,0	7,0	7,0	8,0	8,0	8,0				
h	17,0	26,0	17,0	36,0	36,0	19,0	32	3	230	13024
i	57,0	58,0	57,0	65,0	65,0	65,0				
k	76,0	83,0	93,0	100,0	100,0	106,0	32	4	400	13028
l	45,0	45,0	55,0	60,0	60,0	60,0				
m	3,5	7,0	11,5	12,0	12,0	17,0	32	5	400	1370

Panel Mounting Socket**Outlet**

- Straight
- Screw or screwless terminals
- High temperature resistant contact carrier
- Flange 107 x 100 mm (at 63A)
- Flange 120 x 120 mm (at 125A)
- Protection degree IP67



13104

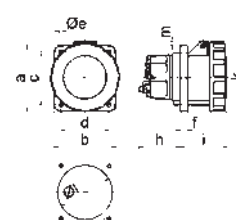

4 MB 55

A	63	125	A	P	V	Art. No.
P	5	5				
a	107,0	120,0	63	3	230	1396
b	100,0	120,0				
c	85,0	100,0	63	4	400	13100
d	77,0	100,0				
e	6,5	6,5	63	5	400	13104
f	12,0	21,0				
h	56,5	50,0	125	3	230	13452
i	76,0	117,0				
k	113,0	129,0	125	4	400	13447
l	88,0	104,0				
m	7,0	6,0	125	5	400	13451

Surface Mounting Socket Outlet

- With Din rail
- Kontex contact
- Nickel plated contacts
- Box terminals
- Protection degree IP67
- with MCB Provision

A	P	V	h	Art. No.
63	4	400	6	15000
63	5	400	6	15001
125	4	400	6	15158
125	5	400	6	15160



Surface Mounting Socket Outlet

- Switched
- Lockable in 0-position
- With mechanical double interlocking
- Nickel plated contacts
- Protection degree IP44

A	P	V	h	Art. No.
16/20	3	230	6	1619
16/20	4	400	6	1610
16/20	5	400	6	1611
32	3	230	6	16097
32	4	400	6	16596
32	5	400	6	16043



Surface Mounting Socket Outlet

- Switched
- Lockable in 0-position
- With mechanical double interlocking
- Kontex contact
- Nickel plated contacts
- Box terminals
- Protection degree IP67

A	P	V	h	Art. No.
63	4	400	6	16604
63	5	400	6	16602
125	4	400	6	16621
125	5	400	6	16622



Surface Mounting Socket Outlet

- Switched
- Lockable in 0-position
- With mechanical double interlocking
- Nickel plated contacts
- Protection degree IP67

A	P	V	h	Art. No.
16/20	3	230	6	1600
16/20	4	400	6	1602
16/20	5	400	6	1604
32	3	230	6	16104
32	4	400	6	160178
32	5	400	6	160177



Surface Mounting Socket Outlet

- Switched
- Interlocked
- Lockable in 0-position
- With Din rail
- Nickel plated contacts
- Protection degree IP67
- With MCB

A	P	V	h	Art. No.
16/20	4	400	6	17176
16/20	5	400	6	17178
32	4	400	6	17180
32	5	400	6	17182



Surface Mounting Socket Outlet

- Switched
- Interlocked
- Lockable in 0-position
- With Din rail
- Nickel plated contacts
- Protection degree IP44
- With MCB

A	P	V	h	Art. No.
16/20	4	400	6	17164
16/20	5	400	6	17163
32	4	400	6	17168
32	5	400	6	17170



Plug Socket Combined in Poly-carbonate Enclosure

- With Din rail
- Nickel plated contacts
- Protection degree IP44
- With MCB Provision

A	P	V	h	Art. No.
16/20	3	230	6	901
16/20	5	415	6	903
32	3	230	6	911
32	5	415	6	913



Plug/ Socket Combined in Metal Enclosure

- With Din rail
- Nickel plated contacts
- Protection degree IP44
- With MCB Provision

A	P	V	h	Art. No.
16/20	3	230	6	1201 SP/DP
16/20	5	415	6	3201
32	3	230	6	1202 SP/DP
32	5	415	6	3202
63	3	230	6	1203
63	5	415	6	3203



QUICK-CONNECT Phase Inverter with MULTI-GRIP

- Screwless terminals
- Nickel plated contacts
- Cable gland Multi-Grip system
- Housing connection with thread and snap-in lock
- Protection degree IP44

**QUICK-CONNECT
MULTI-GRIP**

Ampere	Pole	Voltage	Art. No.	Quantity
16	4	400	22053	10
16	5	400	225	10
32	4	400	22055	10
32	5	400	227	10



227

Phase Inverter with MULTI-GRIP

- Screw terminals
- High temperature resistant contact carrier
- Nickel plated contacts
- Cable gland Multi-Grip system
- Protection degree IP44

MULTI-GRIP

Ampere	Pole	Voltage	Art. No.	Quantity
16	5	230	2286	10
16	5	400	2271	10
32	5	230	2287	10
32	5	400	2288	10



2288

Phase Inverter with MULTI-GRIP

- Screw terminals
- High temperature resistant contact carrier
- Nickel plated contacts
- Cable gland Multi-Grip system
- Protection degree IP67

MULTI-GRIP

Ampere	Pole	Voltage	Art. No.	Quantity
16	5	230	2266	10
16	5	400	2251	10
32	5	230	2267	10
32	5	400	2252	10



2251

Phase Inverter - Surface Mounting Appliance Inlet

- Screw terminals
- High temperature resistant contact carrier
- Nickel plated contacts
- Protection degree IP44

Ampere	Pole	Voltage	Art. No.	Quantity
16	5	230	24208	10
16	5	400	24209	10
32	5	230	24210	10
32	5	400	24211	10



24209

Domestic Panel Mounting Socket Outlet

- Screw terminals
- Hinged lid and injected flange gasket (F)
- Nickel plated contacts (F)
- Protection degree IP54

Earthing Type	Country - System	Colour	Art. No.
Germany	F	blue	71094
Germany	F	grey	71095
Germany	F	black	71097
UK	G	blue	71142

**Domestic Plug**

- Cable gland Multi-Grip system
- Spacious connection area
- Double earthing system
- Protection degree IP44
- Nickel plated contacts

MULTI-GRIP

Earthing Type	Country - System	Colour	Art. No.
Germany	F	blue	7370
Germany	F	grey	7371
Germany	F	black	7372
Germany	F	red	7373



7370

Surface Mounting Socket Outlet

- With Din rail
- Nickel plated contacts
- Protection degree IP44
- With MCB Provision

A	P	V	h	Art. No.
16/20	3	230	6	15019
16/20	5	400	6	15059
32	3	230	6	15030
32	5	400	6	1585
63	5	400	6	15036

**Surface Mounting Socket Outlet**

- With Din rail
- Nickel plated contacts
- Protection degree IP67
- With MCB Provision

A	P	V	h	Art. No.
16/20	3	230	6	15024
16/20	4	400	6	15098
16/20	5	400	6	15028
32	3	230	6	15352
32	4	400	6	15111
32	5	400	6	15112



Technical information

- Container operating voltage 400 - 440V, clock face position 3h
- IEC 60309, EN60309, VDE 0623
- Protection degree IP67

Panel Mounting Socket Outlet TE

- Screw terminals
- High-temperature-resistant contact carrier
- Nickel plated contacts
- Straight
- Protection degree IP67



Ampere	Pole	Art. No.	Quantity
32	4	130156	10

Surface Mounting Socket Outlet QUICK-CONNECT TE

- Screwless terminals
- High-temperature-resistant contact carrier
- Nickel plated contacts
- Protection degree IP67



Ampere	Pole	Art. No.	Quantity
32	4	11556	1

Surface Mounting Socket Outlet TE

- CEE socket with screwless terminals
- Switched
- With mechanical double interlocking
- Lockable in 0-position
- High-temperature-resistant contact carrier
- Nickel plated contacts
- Protection degree IP67



Ampere	Pole	Art. No.	Quantity
32	4	16050	1

Surface Mounting Socket Outlet TE

- CEE socket with screwless terminals
- Switched
- With mechanical double interlocking
- Hinged window
- Lockable in 0-position
- High-temperature-resistant contact carrier
- Nickel plated contacts
- Protection degree IP67



Ampere	Pole	Art. No.	Quantity
32	4	17026	1

Plug TE-Plus with MULTI-GRIP

- Screwless terminals
- High-temperature-resistant contact carrier
- Nickel plated contacts
- Special gland, simultaneous cable gland and seal
- Protection degree IP67



Ampere	Pole	Art. No.	Quantity
32	4	2148509	10

Plug with MULTI-GRIP

- One-piece enclosure
- Nickel plated contacts
- Special gland, simultaneous cable gland and seal
- Protection degree IP67



Ampere	Pole	Art. No.	Quantity
Screw terminal			
32	4	210824	10

QUICK-CONNECT

32	4	21232-TLQ	10
----	---	------------------	----

210824

Appliance Inlet with Flange TE

- Screw terminals
- With closure cap
- High-temperature-resistant contact carrier
- Nickel plated contacts
- Protection degree IP67



Ampere	Pole	Art. No.	Quantity
32	4	27027	10

Closure Cap

- For CEE plugs
- Protection degree IP67



Order no.	
16A / 3p	830
16A / 4p	835
16A / 5, 7p	831
32A / 3p, 4p	837
32A / 5p, 7p	832
63A / 3p, 4p, 5p	833
125A / 3p, 4p, 5p	834

832

Technical information

- Container operating voltage 400 - 440V, clock face position 3h
- IEC 60309, EN60309, VDE 0623
- Protection degree IP67

Connector TE-Plus with MULTI-GRIP

- Screwless terminals
- High-temperature-resistant contact carrier
- Nickel plated contacts
- Special gland, simultaneous cable gland and seal
- Protection degree IP67



Ampere	Pole	Art. No.	Quantity
32	4	310426	10

Connector with MULTI-GRIP

- One-piece enclosure
- Nickel plated contacts
- Special gland, simultaneous cable gland and seal
- Protection degree IP67



Ampere	Pole	Art. No.	Quantity
Screw terminal			
32	4	310567	10
QUICK CONNECT			
32	4	31186-TLQ	10

310567

Test Plug

- Screw terminals
- For testing switch panel
- Nickel plated contacts
- Protection degree IP44



Ampere	Pole	Art. No.	Quantity
32	4	2298	1

Cable Gland MULTI-GRIP with Additional Strain Relief

- For plugs and connectors with MULTI-GRIP cable gland



Order no.	
for 16A / 3p, 4p TE + TE Plus	
16A / 3p, 4p, 5p QC + TLS	29148
for 16A / 5p TE + TE Plus	29149
for 32A / 5p TE + TE Plus	29150
32A / 5p, TE + TE Plus	29132
for 125A / 3p, 4p, 5p TE	29133

VARIABOX-M

Components:

1 CEE socket 32A, 400V, 4p, 3h, IP67
nickel plated contacts, with mechanical interlocking, lockable in 0-position

Fuse:

1 C-type MCB 32A, 3p
1 RCCB 40/0.03A, 4p

Cable entry at top and bottom:

each with 1x M12, 1x M20, 2x M40

Connection option:

2 cables up to 5 x 25 mm²



VARIABOX-L

Components:

2 CEE socket 32A, 400V, 4p, 3h, IP67
nickel plated contacts, with mechanical interlocking, lockable in 0-position

Fuse:

2 C-type MCB 32A, 3p
1 RCCB 63/0.03A, 4p

Cable entry at top and bottom:

each with 1x M12, 1x M20, 2x M40

Connection option:

2 cables up to 5 x 25 mm²



VARIABOX-XL

Components:

3 CEE socket 32A, 400V, 4p, 3h, IP67
nickel plated contacts, with mechanical interlocking, lockable in 0-position

Fuse:

3 C-type MCB 32A, 3p

Cable entry at top and bottom:

each with 1x M12, 1x M20, 2x M40

Connection option:

2 cables up to 5 x 25 mm²



VARIABOX-L DUO

Components:

4 CEE socket 32A, 400V, 4p, 3h, IP67
nickel plated contacts, with mechanical interlocking, lockable in 0-position

Fuse:

4 C-type MCB 32A, 3p
1 RCCB 63/0.03A, 4p

Cable entry at top and bottom:

each with 1x M12, 1x M20, 2x M40

Connection option:

2 cables up to 5 x 25 mm²



High Current Plugs and Sockets Above 125 Amp.

Surface Mounting Socket Outlet, Switched, Electrically Interlocked

- Stainless-steel enclosure AISI 304
- With integrated main switch and socket
- Protection degree IP55

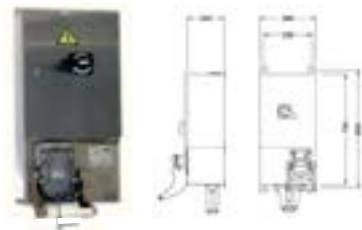

A	P	Order no.	mm ²	Weight kg
250	4	160467		45.0
400	4	160468		45.0
250	5	160469		50.0
400	5	160470		50.0

Surface Mounting Socket Outlet, Switched, Electrically Interlocked

- Stainless-steel enclosure AISI 304
- With integrated main switch and socket
- Protection degree IP55

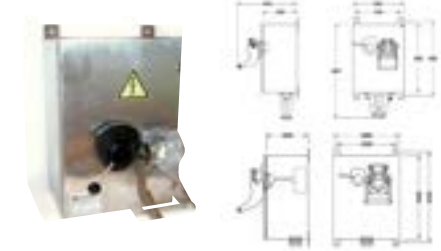

A	P	Order no.	mm ²	Weight kg
250	4	160471		27.0
400	4	160472		27.0
250	5	160473		45.0
400	5	160474		45.0

Panel Mounting Socket Outlet with Easy Locking System and Laminated Contacts

- Metallic plugs and sockets
- Bronze lever arm
- 2 internal pilot contacts for signalling and control purposes
- IP66 when closed



	≤ 250A	< 250A
a	150	200
b	171	225
c	36	93
d	219	
e	46	55
f	46	55
g	49	83
h	43	102
i	ø 98	ø 135
k	4x ø10	4x ø10

A	P	Order no.	mm ²	Weight kg
160	4	13898	≤ 35	3.5
200	4	13899	50	3.5
250	4	13900	70	3.5
320	4	130214	95	7.8
420	4	130215	120/150	7.8
160	5	13901	35	3.5
200	5	13902	50	3.5
250	5	130216	≤ 70	7.8
320	5	130217	95	7.8

Plug, Angled with Easy Locking System

- Metallic plugs and sockets
- External strain relief
- High-temperature-resistant contact carrier
- Silver-plated laminated contacts
- 2 internal pilot contacts for signalling and control purposes
- Plugs and sockets can be protected from dirt and dust by means of an additional protective cap
- IP66 when closed



	≤ 250A	< 250A
a	235	300
ø b	max. 55	max. 72

A	P	Order no.	mm ²	Weight kg
160	4	2318	≤ 35	1.9
200	4	2319	50	1.9
250	4	2320	70	1.9
320	4	2323	95	4.5
420	4	2311	120/150	4.5
160	5	2321	35	1.9
200	5	2322	50	1.9
250	5	2324	≤ 70	4.5
320	5	2316	95	4.5

Order corresponding protective cap- **Order No. 8345**

Plug, Straight with Easy Locking System

- Metallic plugs and sockets
- External strain relief
- High-temperature-resistant contact carrier
- Silver-plated laminated contacts
- 2 internal pilot contacts for signalling and control purposes
- Plugs and sockets can be protected from dirt and dust by means of an additional protective cap
- IP66 when closed



	≤ 250A	< 250A
a	340	465
ø b	max. 55	max. 72

A	P	Order no.	mm ²	Weight kg
160	4	211018	≤ 35	1.8
200	4	211019	50	1.8
250	4	211020	70	1.8
320	4	211021	95	4.5
420	4	211022	120/150	4.5
160	5	211023	35	1.8
200	5	211024	50	1.8
250	5	211025	≤ 70	4.5
320	5	211026	95	4.5

Order corresponding protective cap- **Order No. 8322**

Connector, Straight with Easy Locking System

- Metallic plugs and sockets
- External strain relief
- High-temperature-resistant contact carrier
- Silver-plated laminated contacts
- 2 internal pilot contacts for signalling and control purposes
- IP66 when closed



	≤ 250A	< 250A
a	430	560
ø b	max. 55	max. 72

A	P	Order no.	mm ²	Weight kg
160	4	310697	≤ 35	4.8
200	4	310698	50	4.8
250	4	310318	70	4.8
320	4	310699	95	9.4
420	4	310700	120/150	9.4
160	5	310701	35	4.8
200	5	310702	50	4.8
250	5	310703	≤ 70	9.4
320	5	310704	95	9.4

Solid-Rubber Enclosures, Portable & Hinged Windows

Technical information

- Wired ready for connection
- Protection degree IP44
- All distributors comply with the DIN EN 61439 / IEC 61439

Cross distributor

118 x 118 mm - hanging
Enclosure made of high-grade plastic

Components:

4 Domestic sockets 16A, 230V ~
(system F - German earthing System)

Cable entry/Input:

1x M25

Connection option:

for 1 cable up to 5x 2.5 mm²



Cross distributor

118 x 118 mm - hanging
Enclosure made of high-grade plastic

Components:

3 CEE sockets 16A, 400V, 5p

Cable entry/Input:

1 CEE inlet 16A, 400V, 5p



Hanging distributor

184 x 350 mm - hanging
Enclosure made of high-grade plastic

Components:

2 Domestic sockets 16A, 230V ~
(system F - German earthing System)
2 CEE sockets 16A, 400V, 5p

Protection:

2 C-type MCBs 16A, 1p
2 C-type MCBs 16A, 3p
1 RCCB 40/0.03A, 4p

Cable entry:

1x M40

Connection option:

for 1 cable up to 5 x 10 mm²



Hanging distributor

184 x 350 mm - hanging
Enclosure made of high-grade plastic

Components:

2 Domestic sockets 16A, 230V ~
(system F - German earthing System)
1 CEE socket 16A, 400V, 5p
1 CEE socket 32A, 400V, 5p

Protection:

2 C-type MCBs 16A, 1p
1 C-type MCB 16A, 3p
1 C-type MCB 32A, 3p
1 RCCB 40/0.03A, 4p

Cable entry:

1x M40

Connection option:

for 1 cable up to 5 x 10 mm²



Uni-Block

140 x 140 mm - hanging
Enclosure made of high-grade solid rubber

Components:

4 Domestic sockets 16A, 230V ~
(system F - German earthing System)

Cable entry:

1x M25

Connection option:

for 1 cable up to 5 x 10 mm²



Uni-Block

Enclosure made of high-grade solid rubber

Components:

3 domestic sockets 16A, 230V ~
(type F - Germany)
1 CEE socket 16A, 400V, 5p

Cable entry:

1x M25

Connection option:

1 cable up to 5 x 10 mm²



Hinged Window

- Self-Closing
- Without touch protection

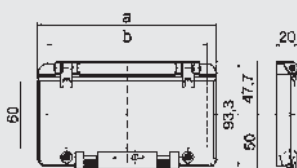

Module unit	Dimension a	Dimension b	Ref. No.
2	55,0	37,0	5882
4	91,0	73,0	5891
6	127,0	109,0	58001
8	162,0	144,5	58010
12	234,0	217,0	58019
13	257,5	240,0	58028

Can only be used in operating windows with
Reef. no.GWE.



VARIABOX

One for all: the VARIABOX meets all requirements for a modern distributor housing and can be individually configured in five different sizes. With versions S, M, L, XL and XXL, as surface-mounting or mobile combination, we always have the right distributor for your needs.

- Fuse elements arranged below transparent, lockable operating window with user-friendly OTC mechanism (one touch close). It engages in the open state and locks again automatically when touched lightly
- Coded flange plate system for maximum safety during initial installation and maintenance
- All CEE sockets with screwless, maintenance-free QUICK-CONNECT technology and standardised flange dimensions, therefore independent of manufacturer if necessary
- Colours: bottom - black, top - electro-grey (enclosure top optionally available in the colours yellow, red or blue)
- Surface mounting or mobile distributor versions in the sizes S (1-module), M (2-modules), L (3-modules), XL (4-modules), XXL (5-modules)
- Ready wired for installation
- Available in the protection degrees IP44, IP54 and IP67
- Enclosure made of high-grade, impact-resistant thermoplastic
- Top and bottom can be sealed together
- With external and internal fastening
- The cover screws are captive and can be actuated using a flat-tip or cross-tip screwdriver or using an internal or external hexagon spanner
- Modular expansion on all 4 sides
- Straight top hinged at side



VARIABOX-S

30MB208

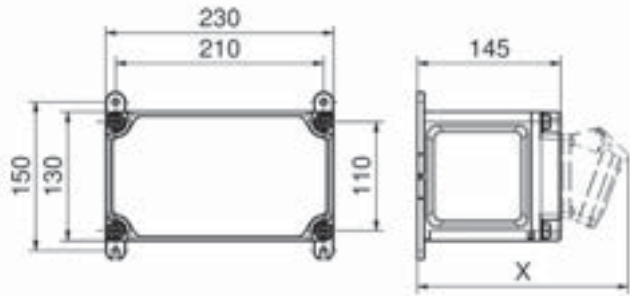

Standard cable entries pre-punched
Top: 1xM12, 1xM20, 2xM25 oder 2xM32
Bottom: 1xM12, 1xM20, 2xM25 oder 2xM32

VARIABOX-M

30MB207

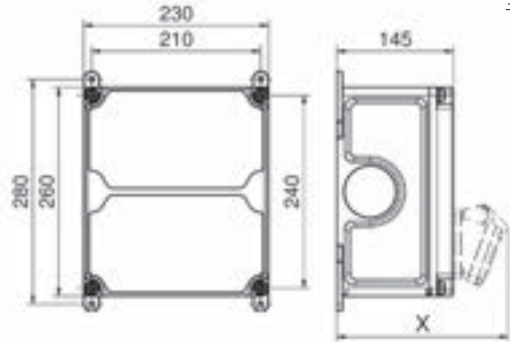

Standard cable entries pre-punched
Top: 1xM12, 1xM20, 2xM32 oder 2xM40
Bottom: 1xM12, 1xM20, 2xM32 oder 2xM40

VARIABOX-L

30MB206

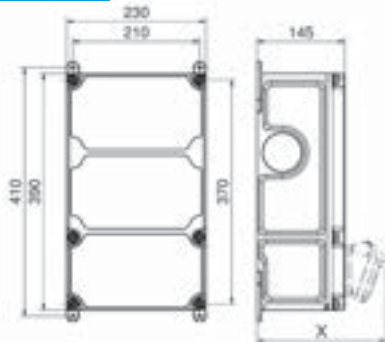

Standard cable entries pre-punched
Top: 1xM12, 1xM20, 2xM40
Bottom: 1xM12, 1xM20, 2xM40

VARIABOX-XL

30MB205

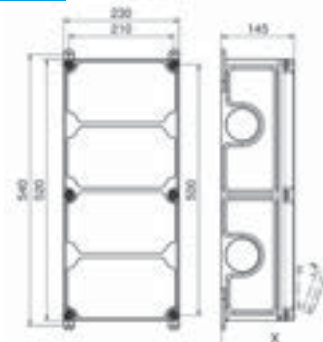

Standard cable entries pre-punched
Top: 1xM12, 1xM20, 2xM40
Bottom: 1xM12, 1xM20, 2xM40

VARIABOX-XXL

30MB204



Standard cable entries pre-punched
Top: 1xM12, 1xM20, 2xM40
Bottom: 1xM12, 1xM20, 2xM40

VARIABOX-L DUO

30MB214

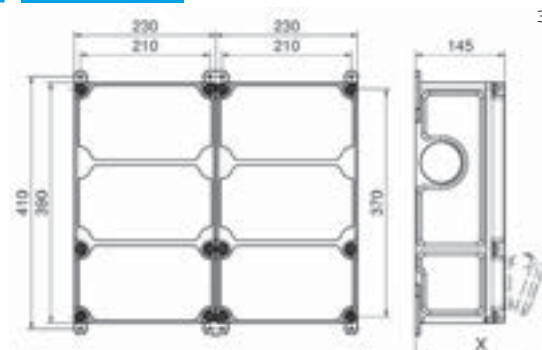

Standard cable entries pre-punched
Top: 1xM12, 1xM20, 2xM40
Bottom: 1xM12, 1xM20, 2xM40

Table X-dimension

Components	Operation window	Schuko-type socket.		CEE 16A 3pole		CEE 16A 4pole		CEE 16A 5pole		CEE 32A 3/4pole		CEE 32A 5pole		CEE 63A	
Protection class		IP44	IP67	IP44	IP67	IP44	IP67	IP44	IP67	IP44	IP67	IP44	IP67	IP44	IP67
Depth X	180	162	205	200	200	204	202	207	205	211	213	213	214	229	231

Technical information

- Wired ready for connection
- Protection degree IP44
- All distributors comply with the DIN EN 61439 / IEC 61439

VARIABOX-S

Components:

2 domestic sockets 16A, 230V
(system F - German earthing system)
1 CEE socket 16A, 400V, 5p

Cable entry at top and bottom:

each with 1x M12, 1x M20, 2x M25

Connection option:

for 1 cable up to 5 x 6 mm²



VARIABOX-M

Components:

2 domestic sockets 16A, 230V
(system F - German earthing system)
1 CEE socket 16A, 400V, 5p

Fuse:

2 C-type MCBs 16A, 1p
1 C-type MCB 16A, 3p
1 RCCB 40/0.03A, 4p

Cable entry at top and bottom:

each with 1x M12, 1x M20, 2x M40

Connection option:

for 2 cables up to 5 x 25 mm²



VARIABOX-L

Components:

2 domestic sockets 16A, 230V
(system F - German earthing system)
1 CEE socket 16A, 400V, 5p
1 CEE socket 32A, 400V, 5p

Fuse:

2 C-type MCBs 16A, 1p
1 C-type MCB 16A, 3p
1 C-type MCB 32A, 3p
1 RCCB 40/0.03A, 4p

Cable entry at top and bottom:

each with 1x M12, 1x M20, 2x M40

Connection option:

for 2 cables up to 5 x 25 mm²



VARIABOX-XL

Components:

2 domestic sockets 16A, 230V
(system F - German earthing system)
1 CEE socket 16A, 400V, 5p
1 CEE socket 32A, 400V, 5p
1 CEE socket 63A, 400V, 5p

Fuse:

2 C-type MCBs 16A, 1p
1 C-type MCB 16A, 3p
1 C-type MCB 32A, 3p
1 RCCB 63/0.03A, 4p

Cable entry at top and bottom:

each with 1x M12, 1x M20, 2x M40

Connection option:

for 2 cables up to 5 x 25 mm²



VARIABOX-M IP67

Components:

1 domestic sockets 16A, 230V
(system F - German earthing system)
1 CEE socket 16A, 400V, 5p

Fuse:

1 C-type MCB 16A, 1p
1 C-type MCB 16A, 3p
1 RCCB 40/0.03A, 4p

Cable entry at top and bottom:

each with 1x M12, 1x M20, 2x M40

Connection option:

for 2 cables up to 5 x 25 mm²



VARIABOX-L IP67

Components:

2 domestic sockets 16A, 230V
(system F - German earthing system)
1 CEE socket 16A, 400V, 5p
1 CEE socket 32A, 400V, 5p

Fuse:

2 C-type MCBs 16A, 1p
1 C-type MCB 16A, 3p
1 RCCB 40/0.03A, 4p

Cable entry at top and bottom:

each with 1x M12, 1x M20, 2x M40

Connection option:

for 2 cables up to 5 x 25 mm²



VARIABOX-M

Components:

1 CEE socket 16A, 400V, 5p, IP44
nickel plated contacts, with mechanical
interlocking, lockable in 0-position

Fuse:

1 C-type MCB 16A, 3p
1 RCCB 40/0.03A, 4p

Cable entry at top and bottom:

each with 1x M12, 1x M20, 2x M40

Connection option:

for 2 cables up to 5 x 25 mm²



VARIABOX-L

Components:

2 CEE socket 16A, 400V, 5p, IP44
nickel plated contacts, with mechanical
interlocking, lockable in 0-position

Fuse:

2 C-type MCBs 16A, 3p
1 RCCB 40/0.03A, 4p

Cable entry at top and bottom:

each with 1x M12, 1x M20, 2x M40

Connection option:

for 2 cables up to 5 x 25 mm²



Product Overview

Rubber Distributors & Customized Portable Distribution Feeder Pillars



Technical Informations

- Housing material: high quality solid rubber
- Wired ready for connection
- All distributors comply with the DIN EN 61439 / IEC 61439

MODBOX®-Midi

Components

6 domestic sockets 16A, 230V ~
(type F - Germany)

Fuse:

6 C-type MCBs 16A, 1p
1 RCCB 40/0.03A, 4p

Cable entry at top and bottom:
each with 2x M40

Connection option:

2 cables up to 5 x 25 mm²



MODBOX®

Components

2 domestic sockets 16A, 230V ~
(type F - Germany)
1 CEE socket 16A, 400V, 5p
1 CEE socket 32A, 400V, 5p

Fuse:

2 C-type MCBs 16A, 1p
1 C-type MCB 16A, 3p
1 C-type MCB 32A, 3p
1 RCCB 63/0.03A, 4p

Cable entry at top and bottom:
each with 2x M40

Connection option:

2 cables up to 5 x 25 mm²



Mobile combination unit

250 x 210 mm - portable

Components:

6 domestic sockets 16A, 230V ~
(type F - Germany)
2 CEE sockets 16A, 400V, 5p
1 CEE socket 32A, 400V, 5p
1 rotary field measuring device

Fuse:

3 C-type MCBs 16A, 1p
1 C-type MCB 16A, 3p
1 RCCB 40/0.03A, 4p

Cable entry/inlet:

CEE phase inverter 32A, 400V, 5p



Mobile combination unit

320 x 245 mm - portable

Components:

4 domestic sockets 16A, 230V ~
(type F - Germany)
2 CEE sockets 16A, 400V, 5p
2 CEE sockets 32A, 400V, 5p

Fuse:

2 C-type MCBs 16A, 1p
2 C-type MCBs 16A, 3p
2 C-type MCBs 32A, 3p
1 RCCB 63/0.03A, 4p

Cable entry/inlet:

CEE plug 63A, 400V, 5p with
cable 3 m H07RN-F5G10



Uni-Block

140 x 140 mm - portable

Components:

2 domestic sockets 16A, 230V ~
(type F - Germany)
2 CEE sockets 16A, 400V, 5p

Cable entry/inlet:

CEE plug 16A, 400V, 5p with
cable 2 m H07RN-F5G2,5



Uni-Block

140 x 140 mm - portable

Components:

4 Domestic sockets 16A, 230V ~
(system F - German earthing System)

Cable entry/inlet:

Domestic plug 16A, 230V, 3p
4 m cable H07RN-F3G2,5



Portable Distribution Feeder Pillar

- Good For Construction Sites
- Made in CRCA Enclosure
- Customized as per site requirement
- Individual / Combined Protection thru MCB / RCCB / RCBO
- Stand made of Round / Rectangular pipe
- Single Phase / Three Phase
- Combination of Sockets
- Handy & easily movable



Customized & IP 65 L.V. Distribution Panels

- L.V. Panel built upto 1600Amp. in Polycarbonate Enclosure
- Customized as per site/client specifications





Corporate & Mktg. Office

A 11 - Sector 59, Noida - 201301, India

Tel: 0120 420 5900, 429 7900

For Product enquiry: +91 955 550 0300

Email: enquiry@neptuneindia.com



www.neptuneindia.com